



ENIB Co., Ltd.

GCA PNEUMATIC VALVE

GENERAL CHEMICAL APPLICATION- PIPE CONNECTION TYPE-HIGH FLOW

OVERVIEW

GCA Pneumatic valve's all wetted parts are made of PFA material, and the valve is designed to generate optimal performance in handling high-purity chemicals

FEATURES

1. Made only of high-purity Fluoropolymer material and is designed to generate optimal performance in handling high-purity chemicals.
2. Bonnet is screwed onto the body(All-in-one assembly) to prevent valve deformation and improve airtightness.
3. The Bonnet Lock and fitting Nut Lock stabilize and prevent loosening of valve components adding additional safety.
4. Visually identifiable on and off indicator for precise valve operation

TECHNICAL DATA

Actuator Type	Pneumatic Air Operation			
Connection Type	ENIB Pipe Connection			
Configuration	2-Way Flow / Orifice			
Air Port	1/8"PT(Female)			
Supply Pressure	Minimum 6 ~ Maximum 7kg/cm ² (86~100 psi)			
Model Number	Size	Orifice	Cv	Port Configuration
GPV-P-40	40A	40.86	38.3	40A Pipe Connection
GPV-P-50	50A	52.5	51.1	50A Pipe Connection

Operating Temperature	Operating Pressure
0 ~ 90 °C	9kg/cm ² (0.9Mpa)
90 ~ 120 °C	7kg/cm ² (0.7Mpa)

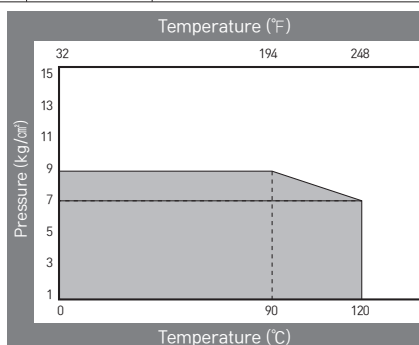

High Flow Pipe Type Size
40A, 50A

2-WAY FLOW PATTERNS

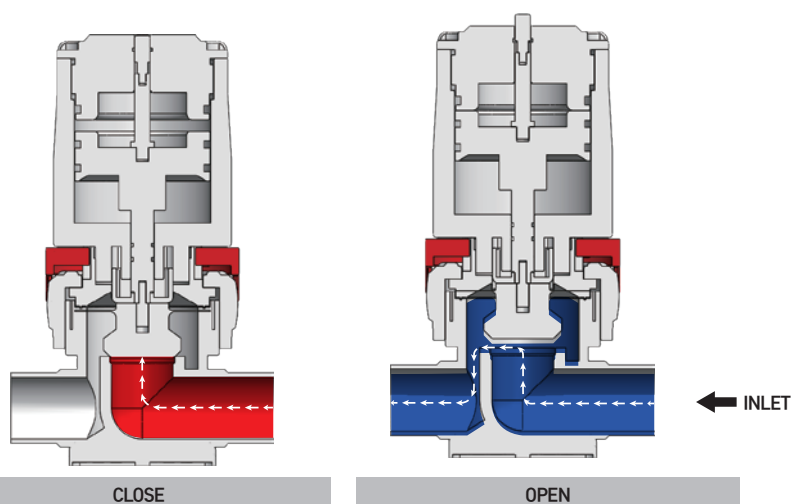

MATERIAL CONSTRUCTION & DIMENSION TABLE

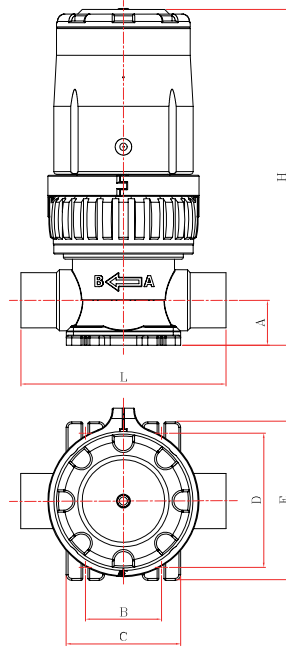
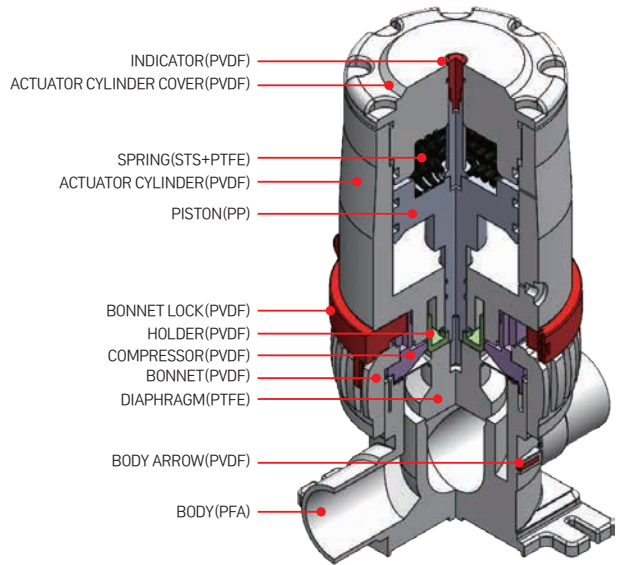

Size	A	H	L	B	C	D	E
40A	1.93"(49mm)	14.43"(366.5mm)	8.82"(224mm)	3.27"(83mm)	4.92"(125mm)	5.89"(149.5mm)	6.81"(173mm)
50A	1.93"(49mm)	14.43"(366.5mm)	8.82"(224mm)	3.27"(83mm)	4.92"(125mm)	5.89"(149.5mm)	6.81"(173mm)

HOW TO ORDER

[Normal Close Type]

Type	CODE
GCA PNEUMATIC VALVE Normally Close Type	GPV

Connection	CODE
PIPE	P

SIZE	CODE
40A	40
50A	50

Example : GPV-P-40

GPV	GCA PNEUMATIC VALVE Normally Close Type
P	PIPE
40	40A

“ SMART VALUE OPERATION PRODUCT LINE UP ”

ENIB (Extrusion & Injection, Basic Co., Ltd) Corporate Mission :

ENIB is to become a key provider of safe, high performance, and advanced technology device and components for fluid management systems and applications that meet or exceed the needs and requirements of global customers.

62, BANSAN 2-RO, MUNMAK-EUP, WONJU-SI,
GANGWON-DO, REPUBLIC OF KOREA
Customer Service Tel : +82 033-743-9200
Customer Fax : +82 033-743-9201
www.enib.co.kr